

AMEND THE LEDUC COUNTY LAND USE BYLAW NO. 7-08

BYLAW NO. __-22

LEDUC COUNTY

A BYLAW OF LEDUC COUNTY, IN THE PROVINCE OF ALBERTA, TO AMEND THE LEDUC COUNTY LAND USE BYLAW NO. 7-08.

WHEREAS

pursuant to Sections 640(1) of the Municipal Government Act, being Chapter M-26, Revised Statutes of Alberta, 2000, and amendments thereto, the Council of Leduc County may pass a bylaw to amend the Leduc County Land Use Bylaw 7-08.

NOW THEREFORE

be it resolved that the council of Leduc County, duly assembled, enacts that Bylaw No. 7-08 be amended as follows:

1. That those lands described as Pt. NE 5-51-24-W4 affecting 32.39 ha (80.04 ac) be redistricted from the Agricultural (AG) District to the Light Industrial (LI) District, as shown on the attached Schedule A.
2. This bylaw shall take effect on the date of third reading.

Read a first time this __ day of __, A.D. 2022.

MAYOR

COUNTY MANAGER

Read a second time this __ day of __, A.D. 2022.

Read a third time and passed this __ day of __, A.D. 2022.

MAYOR

COUNTY MANAGER

AMEND THE LEDUC COUNTY LAND USE BYLAW NO.7-08

BYLAW NO. __-22

Page 2

Schedule "A"

Bylaw XX-22

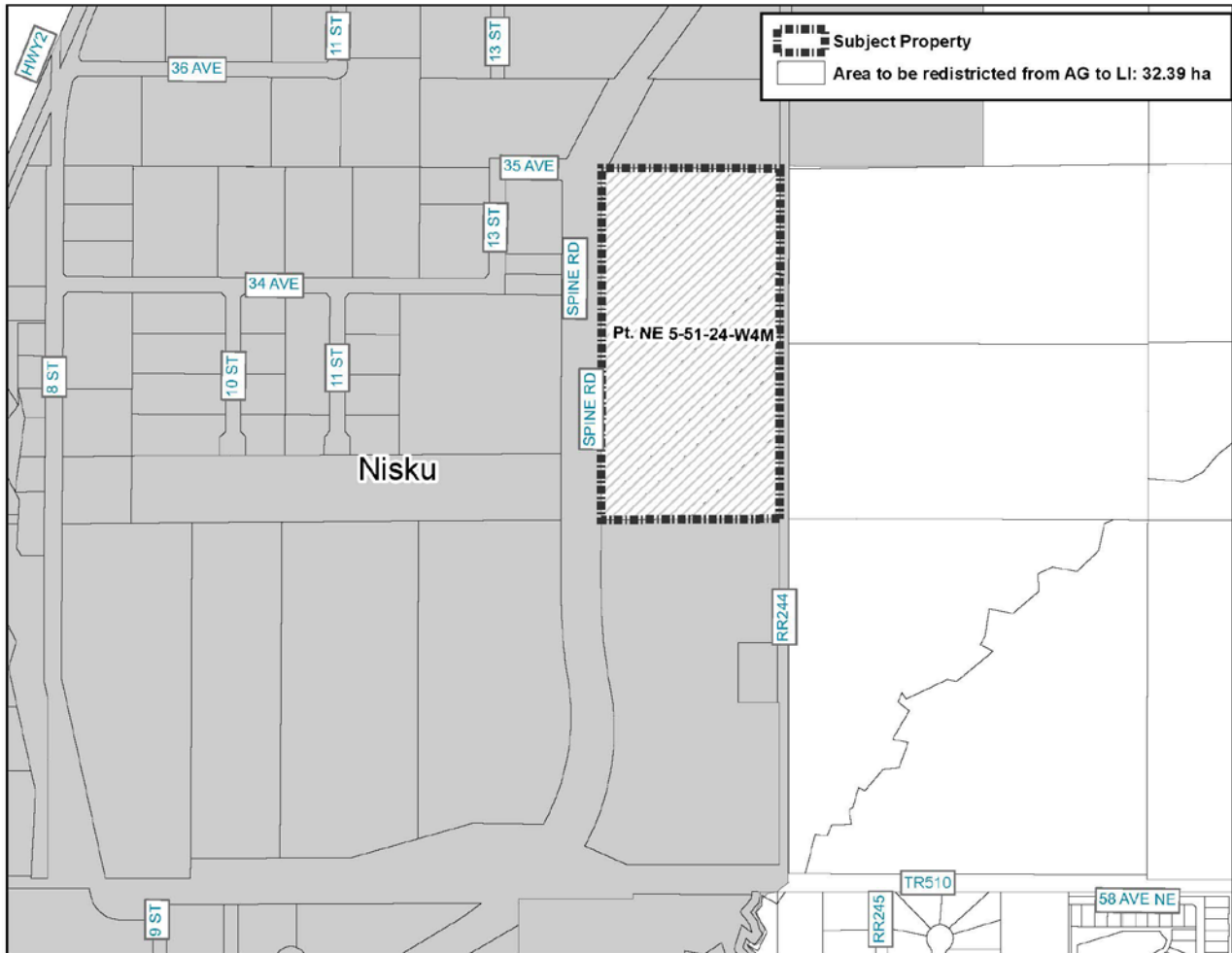

 LEDUC COUNTY	To Redistrict: 32.39 ha± (80.04 ac±)
	Location: Pt. NE 5-51-24-W4
	From: AG – Agricultural
	To: LI – Light Industrial
	File: LA21-004